

Creating Films For Printmaking

Printing Acetate on WSA Laser Printers

- 1 **Print your paper original**
- 2 **Check for compatibility**
- 3 **Load your paper original**

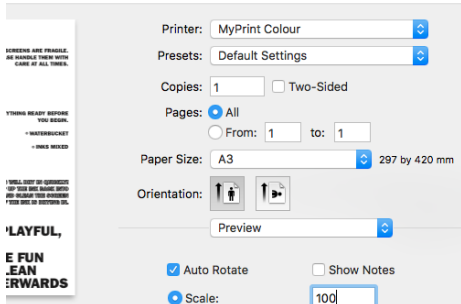

Print your PDF on to paper using MyPrint Colour setting. Set the scale to 100% in the print dialog box before printing.

Ensure you are using an acetate compatible MFD Printer by looking for the green label on the device.

Load your paper original into the copy feed tray or place it directly on the glass ready to copy.

- 4 **Load the bypass tray**
- 5 **Confirm media size & type**
- 6 **Set media size & type for A3**

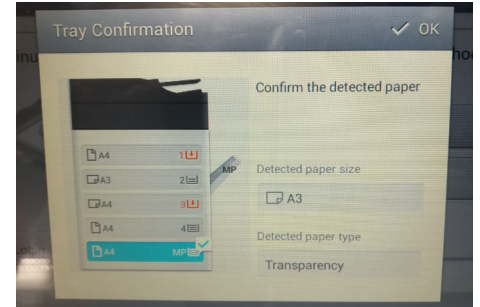
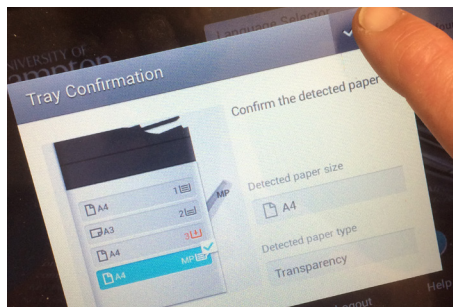
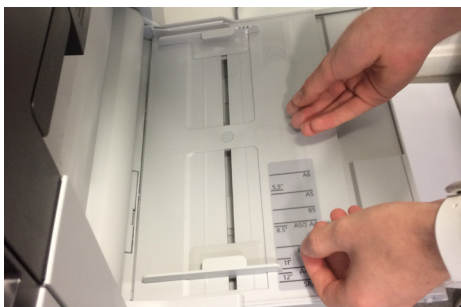

Load the correct sized **laser compatible acetate** into the bypass tray (MP Tray) on the laser printer.

Set the paper size to A4 and select Transparency as the media type. **For printing A4 skip to step 7**

Remove your acetate from the MP tray and reload it. The printer will detect A3 size and retain the transparency setting.

- 7 **Select the bypass tray**
- 8 **Adjust the contrast**
- 9 **Copy your paper original**

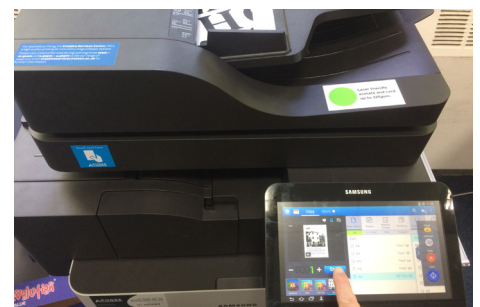
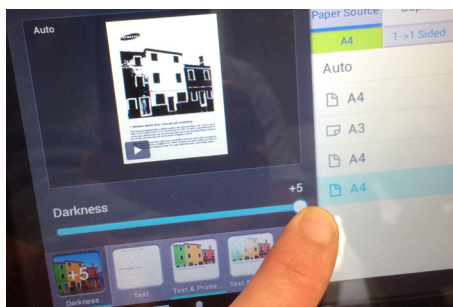
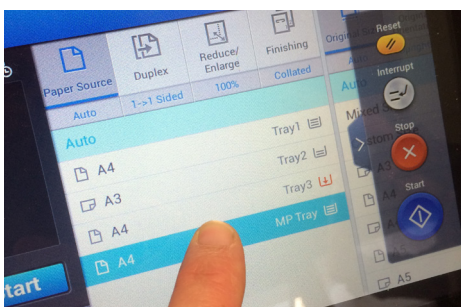

Select the bypass tray (MP Tray) as the paper/media source.

Set to Full Colour and adjust the contrast to +5 using the Darkness setting on the printer.

Press start to copy your artwork onto the acetate. Check to ensure it is dark enough for the screen exposure process.

Acetate Compatible Printer Locations

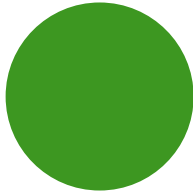

Laser friendly acetate and card up to 325gsm.

Only selected MFD printers at Winchester School of Art are capable of printing onto acetate. You must ensure you are using one of these printers for creating film positives on acetate and that you are using **laser compatible acetate** purchased from WSA only.

